



VERSA COMMERCIAL

6" LED COMMERCIAL DOWNLIGHT NEW CONSTRUCTION

JOB INFORMATION	TYPE:
	CATALOG NO.:
	PROJECT NAME:
	COMMENTS:
PREPARED BY:	

6" LED COMMERCIAL DOWNLIGHT NEW CONSTRUCTION

FEATURES

USE OF PRODUCT

The 6" Versa Commercial LED Downlight is the ideal product for energy efficient lighting in Non-IC New Construction commercial applications. Available with interchangeable reflectors and trims, with an assortment of color temperatures, lenses, filters and dimmable driver options.

VERSA COMMERCIAL FEATURES

Wattage	Lumens	Voltage	CRI
11W	1,025 lm	120-277V	93+
16W	1,300 lm	120-277V	93+
20W	1,600 lm	120-277V	93+
21W	1,870 lm	120-277V	93+
30W	2,070 lm	120-277V	93+
31W	2,435 lm	120-277V	93+
38W	2,930 lm	120-277V	93+
45W	3,280 lm	120-277V	93+
58W	4,000 lm	120-277V	93+

*Performance based on 3000K

Color Temperature: 2700K, 3000K, 3500K, or 4000K

SDCM: 2 step binning

Color Rendering Index: 93+ CRI

R9: 60+

Optical Lens: 18°, 30°, 50°, 80°

Filter Accessories: Solite, frosted, or honeycomb

LED Life: 50,000 Hours

LED Type: Cree LED

Driver Info: 120-277V, 50/60 Hz, PF>0.9, THD<0.20

Versatility: Interchangeable reflector/trim, optics & filters

Warranty: 5 year limited warranty

LED ENGINE

LED engine available with CREE LEDs in 2700K, 3000K, 3500K, or 4000K in standard 93+ CRI. 2 Step MacAdam ellipse allows for color consistency between fixtures. LED mounted to aluminum heat sink for maximum life output and thermal management.

FRAME CONSTRUCTION

Constructed from 16 gauge heavy duty powder coated cold rolled steel frame with a large access junction box.

OPTICAL LENS (Field Replaceable)

Field replaceable optical lens available in 18°, 30°, 50° and 80°. Easily achieve narrow spot to wide flood beam pattern.

FILTER ACCESSORIES

A multitude of filter accessories are available to achieve a particular light effect. Available in frosted, honeycomb or solite filter options.

DIMMING

Available in 7 driver selections. (ID) Standard all-inclusive ELV, Triac, and 0-10V dimming driver called Intelligent Drive, 120-277V. (PEQ0) Lutron Hi-Lume Premier Ecosystem 0.1% w/soft on, fade to black dimming, 120-277V. (LDE1) Lutron Hi-Lume 1% Ecosystem with soft on, fade to black dimming, 120-277V. (L3DA) Hi-lume 1% EcoSystem/3-Wire L3D Driver (EEI) eldoLED Eco 1% Dim (0-10V), 120-277V. (EDIO) eldoLED Solo 0.1% Dim(0-10V), 120-277V. (EDID) eldoLED Solo 0.1% Dim(DALI), 120-277V.

VERSATILITY

The Versa Commercial LED Downlight series provides for interchangeable reflectors and trims in round shape with an assortment of finishes to achieve a particular look. The ability to field install and/or replace various reflectors, trims, optics & filters makes the Versa Commercial Downlight Series the most flexible commercial downlight in the industry.

EMERGENCY BATTERY

Optional emergency battery available for a minimum of 90 minutes with both integral or remote test switch in 800 or 1700 delivered lumens

INSTALLATION

Non-IC housing. Insulation must be kept at least 3" away from fixture.

LABELS/COMPLIANCE/WARRANTY

-CSA Listed for US and Canada
-5 year limited warranty.



ORDERING INFORMATION

Series	Lumens	Color Temp	Voltage	Dimming	Optical Lens
RVC6	10L - 1025 lm	27 - 2700K	UNV - 120-277V	ID ² - Standard all-inclusive ELV, Triac, and 0-10V dimming driver (Intelligent Drive)	18 - 18° Beam
	13L - 1300 lm	30 - 3000K	1 - 120V	PEQ0 ³ - Lutron Hi-Lume Premier Ecosystem 0.1% w/soft on, fade to black dimming	30 - 30° Beam
	16L - 1600 lm	35 - 3500K	3 ¹ - 347V	LDE1 ⁵ - Lutron Hi-Lume 1% Ecosystem with soft on, fade to black dimming	50 - 50° Beam
	18L - 1870 lm	40 - 4000K		L3DA - Hi-lume 1% EcoSystem/3-Wire L3D Driver	80 - 80° Beam
	20L - 2070 lm			EEI ⁶ - eldoLED Eco 1% Dim (0-10V)	
	24L - 2435 lm			EDIO ⁶ - eldoLED Solo 0.1% Dim (0-10V)	
	29L - 2930 lm			EDID ⁶ - eldoLED Solo 0.1% Dim (DALI)	
	32L - 3280 lm				
	40L - 4000 lm				

Reflector	Trim	Frame	Frame Accessories	Options
6RW - White	6TW - White	FN - New Construction	C - C Channel bar hanger	E18 - Emergency Battery with Integral Switch (800 Lumens)
6RS - Specular Clear	6TS - Specular Clear		B - Flat bar hanger	ER8 - Emergency Battery with Remote Switch (800 Lumens)
6RH - Haze	6TH - Haze		WJ - Wood joist	E17 - Emergency Battery with Integral Switch (1700 Lumens)
6RB - Black	6TB - Black			ER17 - Emergency Battery with Remote Switch (1700 Lumens)
MTO - Made to order	MTO - Made to order			LAW - Lutron Athena Wireless Node (RF only version)
				WL - Wet Location
				F - Frosted filter
				H - Honeycomb
				S - Solite filter

- Step down transformer required.
- Intelligent Drive is the standard driver for the Versa Commercial.
- Driver must not exceed 20W
- 120V only.
- Inapplicable to 4000 Lumen offering.
- Must specify logarithmic or linear eldoLED driver.



www.rayonlighting.com
info@rayonlighting.com

tel: 323.446.2626
fax: 323.446.2606

Specification and product availability
subject to change without notice

07/23

FRAME ACCESSORIES

WJ

Slotted Holes allow for an easier installation

Wood Joist

4" up to 8" CKOs

Fits up to 26" stud spacings

Plate is offset, allowing for adjustability with irregular stud spacing

B

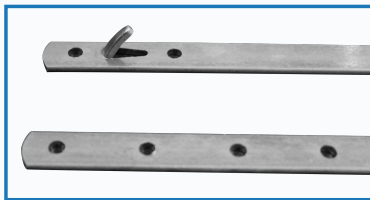

Flat Bar Hanger

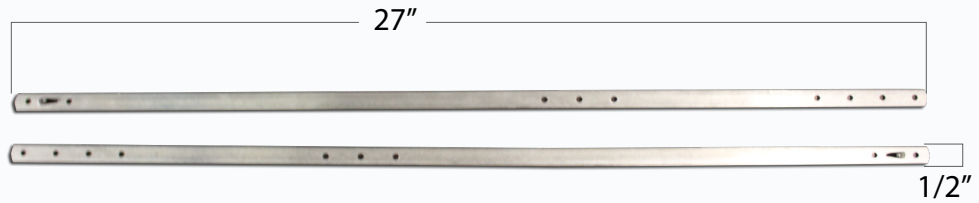

1/2"

C



C Channel Bar Hanger



1-6/16"

VERSA COMMERCIAL

6" LED COMMERCIAL DOWNLIGHT
NEW CONSTRUCTION

PROJECT:

MODEL #:

LOCATION:

CONTACT:

DIMENSIONS

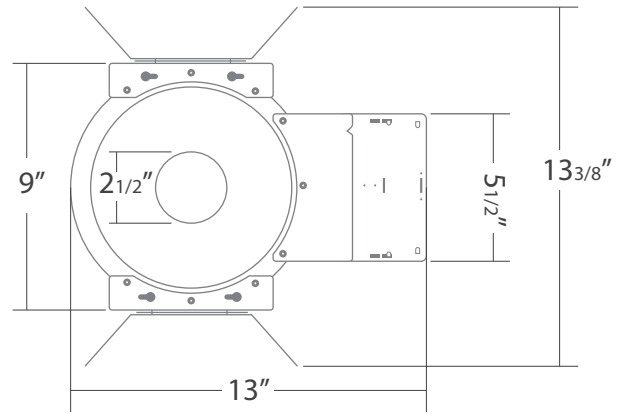
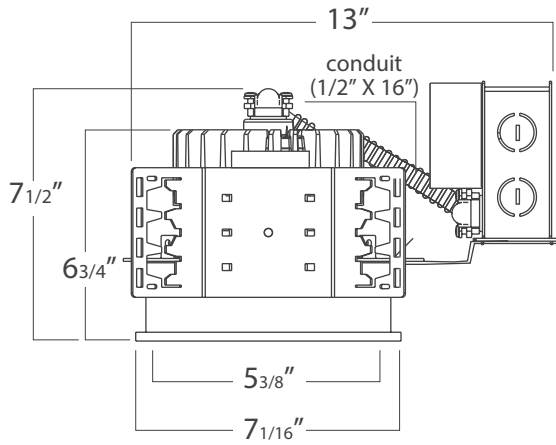

REFLECTOR/TRIM DIMENSIONS

REFLECTOR

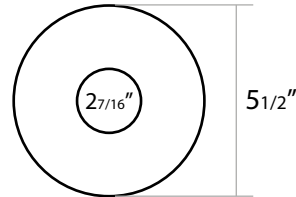
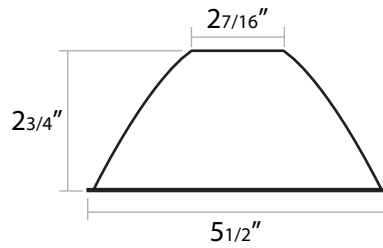

TRIM

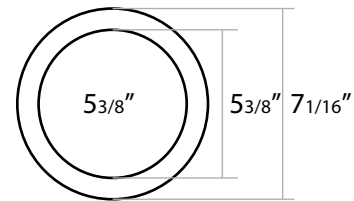
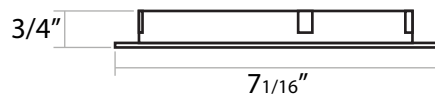

LED HEIGHT INSIDE DOWNLIGHT

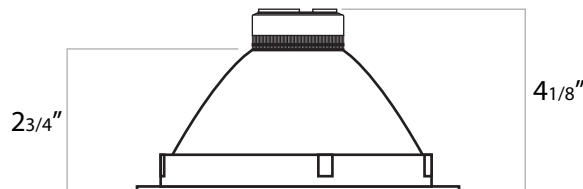

ANATOMY

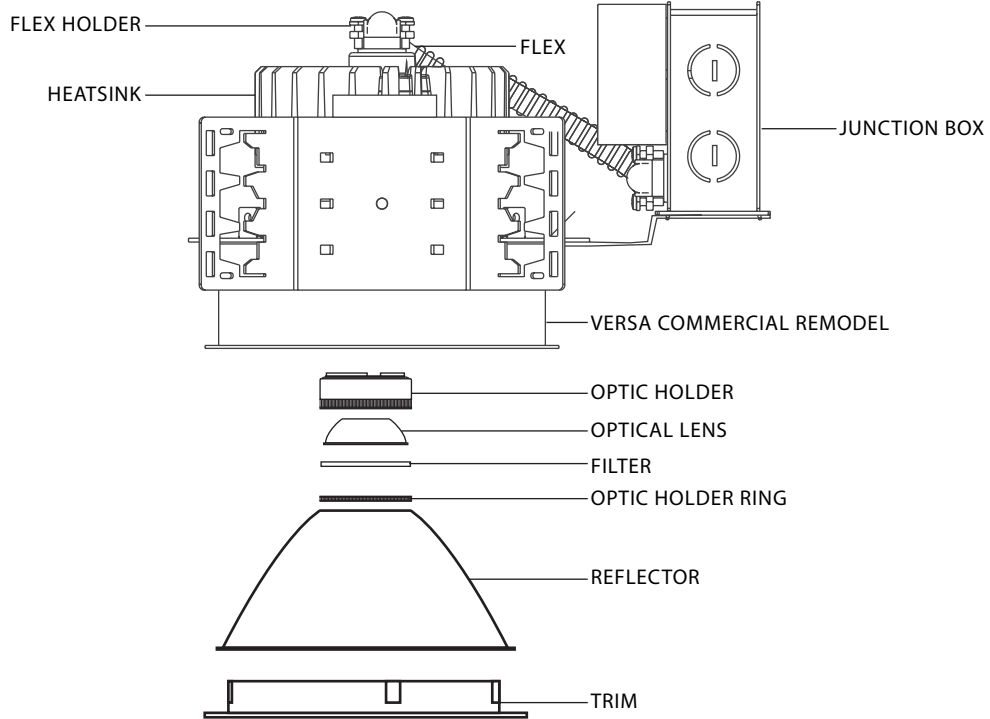

PHOTOMETRICS

30° BEAM

TEST DATE 18Sep16
SERIES RVC6
FRAME New Construction
LUMENS 4102.2
WATTS 57.382

POLAR CANDELA DISTRIBUTION

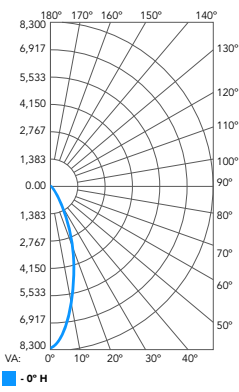

CANDELA DISTRIBUTION

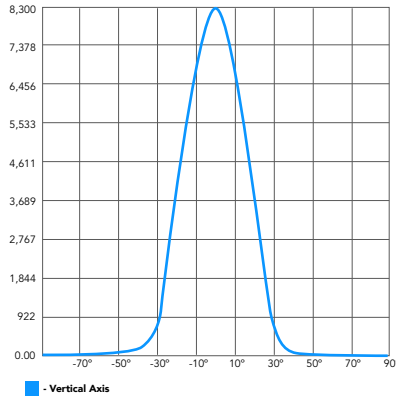

LUMENS PER ZONE

ZONE	LUMENS	% TOTAL
0-10	693.1	16.9%
10-20	1,425.9	34.8%
20-30	1,198.2	29.2%
30-40	529.4	12.9%
40-50	112.7	2.7%
50-60	62.4	1.5%
60-70	44.0	1.1%
70-80	26.9	0.7%
80-90	9.2	0.2%

LCS TABLE

BUG RATING	B3 - UX - GO	
	LUMENS	LUMENS%
FORWARD LIGHT		
LOW(0-30):	1,600.0	39%
MEDIUM(30-60):	326.0	7.9%
HIGH(60-80):	31.7	0.8%
VERY HIGH(80-90):	3.1	0.1%
BACK LIGHT		
LOW(0-30):	1,721.1	42%
MEDIUM(30-60):	378.6	9.2%
HIGH(60-80):	39.2	1%
VERY HIGH(80-90):	6.1	0.1%
TRAPPED LIGHT:	0.000	0%

ILLUMINANCE AT A DISTANCE

H HEIGHT(FT)	CENTER BEAM FOOTCANDLE	BEAM SPREAD(FT)		FIELD SPREAD(FT)	
		HORIZONTAL	VERTICAL	HORIZONTAL	VERTICAL
4.00	514.49 FC	2.7	2.7	5.6	5.6
8.00	128.62 FC	5.5	5.5	11.1	11.1
12.00	57.17 FC	8.2	8.2	16.7	16.7
16.00	32.16 FC	10.9	11.0	22.2	22.3
20.00	20.58 FC	13.7	13.7	27.8	27.9
		BEAM ANGLE		FIELD ANGLE	
		37.7°	37.9°	69.6°	69.7°

50° BEAM

TEST DATE 16Sep16
SERIES RVC6
FRAME New Construction
LUMENS 3656.7
WATTS 59.0943

POLAR CANDELA DISTRIBUTION

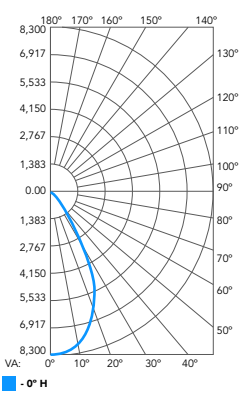

CANDELA DISTRIBUTION

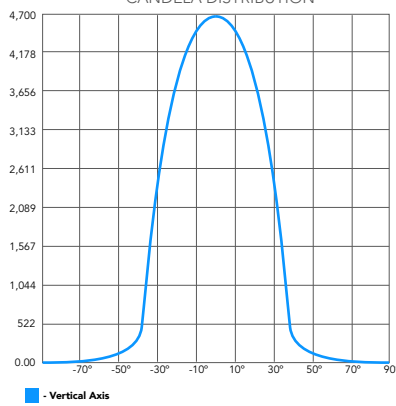

LUMENS PER ZONE

ZONE	LUMENS	% TOTAL
0-10	432.0	11.1%
10-20	1,141.0	29.2%
20-30	1,323.5	33.9%
30-40	678.1	17.4%
40-50	145.8	3.7%
50-60	83.3	2.1%
60-70	57.3	1.5%
70-80	34.78	0.9%
80-90	11.2	0.3%

LCS TABLE

BUG RATING	B3 - UX - GO	
	LUMENS	LUMENS%
FORWARD LIGHT		
LOW(0-30):	1,411.9	38.6%
MEDIUM(30-60):	408.2	11.2%
HIGH(60-80):	42.7	1.2%
VERY HIGH(80-90):	4.1	0.1%
BACK LIGHT		
LOW(0-30):	1,486.5	40.7%
MEDIUM(30-60):	499.3	13.7%
HIGH(60-80):	49.2	1.3%
VERY HIGH(80-90):	7.1	0.2%
TRAPPED LIGHT:	0.000	0%

ILLUMINANCE AT A DISTANCE

H HEIGHT(FT)	CENTER BEAM FOOTCANDLE	BEAM SPREAD(FT)		FIELD SPREAD(FT)	
		HORIZONTAL	VERTICAL	HORIZONTAL	VERTICAL
4.00	291.87 FC	4.4	4.4	6.4	6.4
8.00	72.97 FC	8.7	8.8	12.9	12.8
12.00	32.43 FC	13.1	13.2	19.3	19.2
16.00	18.24 FC	17.4	17.6	25.7	25.6
20.00	11.67 FC	21.8	22.0	32.2	32.0
		BEAM ANGLE		FIELD ANGLE	
		57.1°	57.6°	77.6°	77.3°

PROJECT:

MODEL #:

LOCATION:

CONTACT:

PHOTOMETRICS

70° BEAM

TEST DATE 18Sep16
SERIES RVC6
FRAME New Construction
LUMENS 3657
WATTS 57.566

POLAR CANDELA DISTRIBUTION

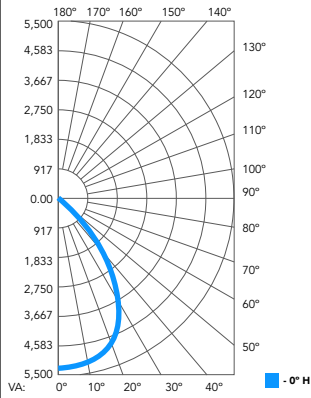

CANDELA DISTRIBUTION

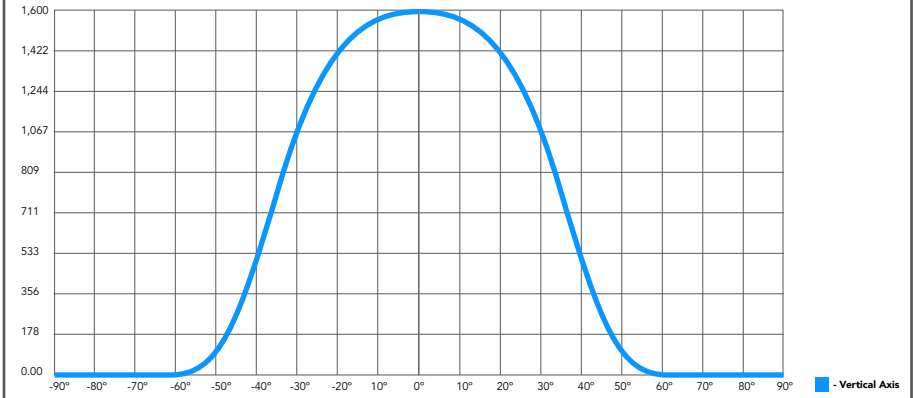

LUMENS PER ZONE

ZONE	LUMENS	% TOTAL
0-30	2,232.3	61.1%
0-40	3,197.4	87.5%
0-60	3,653.1	100%
60-90	0.000	0%
70-100	0.000	0%
90-120	0.000	0%
0-90	3,653.1	100%
90-180	0.000	0%
0-180	3,653.1	100%

LCS TABLE

BUG RATING	B3 - U0 - GO	
	LUMENS	LUMENS%
FORWARD LIGHT		
LOW(0-30):	1,116.6	30.6%
MEDIUM(30-60):	710.7	19.5%
HIGH(60-80):	0.000	0%
VERY HIGH(80-90):	0.000	0%
BACK LIGHT		
LOW(0-30):	1,116.6	30.6%
MEDIUM(30-60):	710.7	19.5%
HIGH(60-80):	0.000	0%
VERY HIGH(80-90):	0.000	0%
UP LIGHT		
LOW(90-100):	0.000	0%
HIGH(100-180):	0.000	0%
TRAPPED LIGHT:	0.000	0%

ILLUMINANCE AT A DISTANCE



H HEIGHT(FT)	CENTER BEAM FOOTCANDLE	D		D	
		BEAM SPREAD(FT)		FIELD SPREAD(FT)	
		HORIZONTAL	VERTICAL	HORIZONTAL	VERTICAL
4.00	190.13 FC	5.7	5.7	8.8	8.8
8.00	47.53 FC	11.4	11.3	17.6	17.6
12.00	21.13 FC	17.0	17.0	26.5	26.4
16.00	11.88 FC	22.7	22.6	35.3	35.2
20.00	7.61 FC	28.4	28.3	44.1	44.0
		BEAM ANGLE		FIELD ANGLE	
		70.7°	70.6°	95.6°	95.5°